

Steel

# HEX REDUCER COUPLINGS

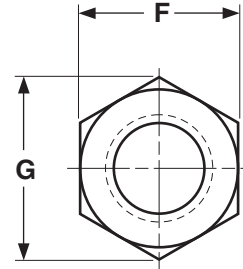
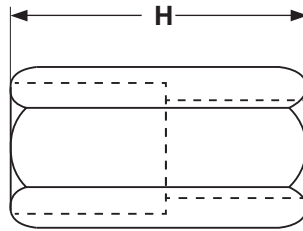

Hex Reducer Coupling Nuts											Coupling Nut Supply
Nominal Size and Threads per Inch	Basic Major Diameter of Thread	Opposite Nominal Size and Threads per Inch	Opposite Basic Major Diameter of Thread	F			G		H		
				Width Across Flats			Width Across Corners		Length		
				Basic	Max	Min	Max	Min	Basic	Max	Min
3/8-16	0.3750	1/4-20	0.2500	1/2	0.500	0.489	0.577	0.557	1	1.01	0.98
1/2-13	0.5000	3/8-16	0.3750	5/8	0.625	0.607	0.722	0.692	1-1/4	1.26	1.19
5/8-11	0.6250	1/2-13	0.5000	13/16	0.813	0.782	0.939	0.891	1-1/4	1.26	1.19
3/4-10	0.7500	5/8-11	0.6250	1	1.000	0.963	1.155	1.097	1-1/2	1.51	1.44

## LOW CARBON

<b>Description</b>	A double chamfered hex nut with two different internal thread sizes at opposite ends of the nut. The length of the nut is greater than 2.5D where D equals the basic major thread diameter. Also referred to as rod couplings.
<b>Applications/ Advantages</b>	Used to join a larger diameter threaded rod to a smaller diameter threaded rod.
<b>Material</b>	1010 - 1018 or equivalent steel. 12L14 steel is commonly used in domestically manufactured coupling nuts.
<b>Hardness</b>	Rockwell B68 - C32
<b>Proof Load</b>	75,000 psi. minimum
<b>Plating</b>	See Appendix-A for plating information.